



PLOTS FOR SALE

# KNS STAR CITY

Anekal (v), Kasaba (H), Bengaluru Urban (Tq)

**BOOK NOW**





# EDUCATIONAL INSTITUTIONS

- Vidhatha Global School
- St. Joseph's School
- Shanthinikethana Vidya Mandira
- Lincoln Memorial English School



# HEALTH CARE

- Dr. Venu Ortho Care and
- Diagnostics
- Sri Sai Clinic Anekal
- Sri Gowri Dantha Chikithsalaya



# ENTERTAINMENTS

- Anekal Govt Basketball court
- Anekal Stadium
- Natya Mayuri Vagdevi Kala Kendra
- Sri Lakshmi Narasimha Theatre
- Muttalmudu Falls
- Annapurneswari Theatre

# LAYOUT PLAN

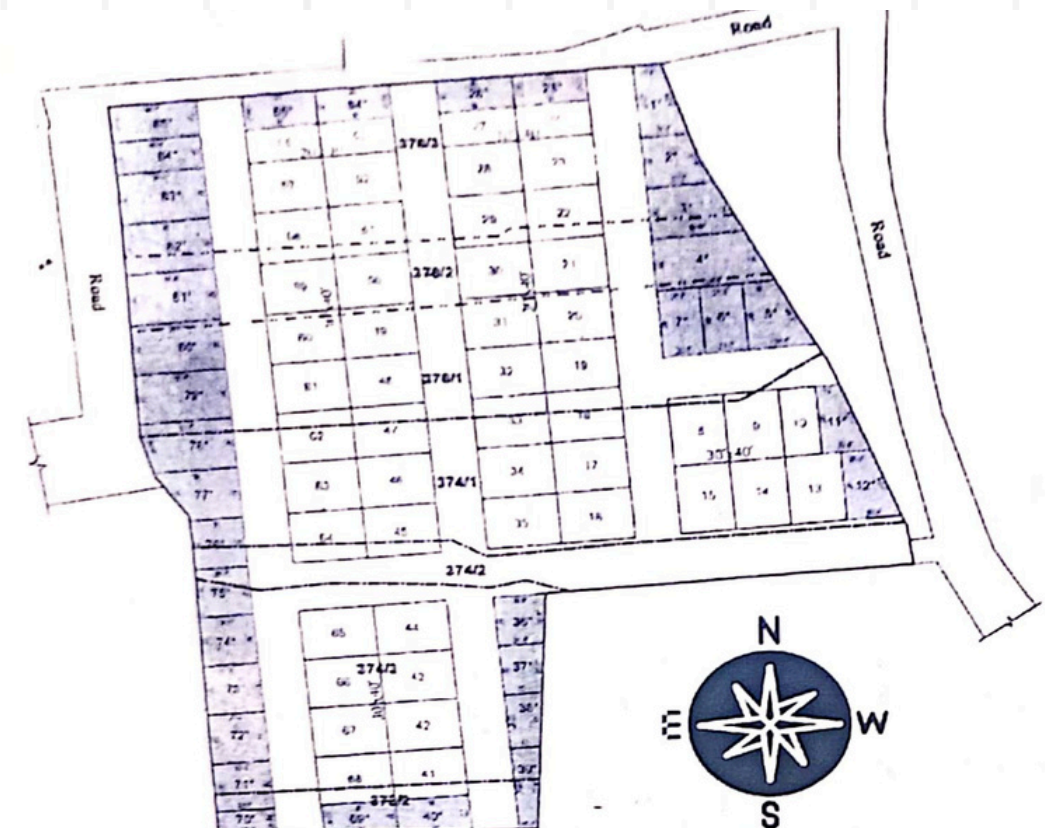

# AMENITIES

- Gated Community
- Electricity
- All round
- compound wall
- Black Top Road
- 24/7 security
- Water Connection to each plot
- Sewage
- Drainage

## Nearest Airport:

**Kempegowda International Airport (BLR) – ~60 km**  
**Accessible via NICE Road or Outer Ring Road + NH44**

# BANK LOANS AVAILABLE

# CONNECTIVITY

## BUS CONNECTIVITY (BMTC & KSRTC):

- **BMTC buses frequently run to:**
  - Electronic City
  - Bommasandra
  - Silk Board
  - KR Market
- **KSRTC and private buses to:**
  - Hosur
  - Kanakapura
  - Nearby towns & villages

## ROAD CONNECTIVITY:

- Hosur Road (NH 44) – Major highway connecting Anekal to Bengaluru and Hosur.
- Anekal–Chandapura Road – Connects to Chandapura and Electronic City.
- Sarjapur–Attibele Road – Connects Anekal to Sarjapur and Attibele.





PLOTS START FROM

**RS. 2299/- PER SQFT.**

SCAN FOR  
LOCATION

Follow Us On

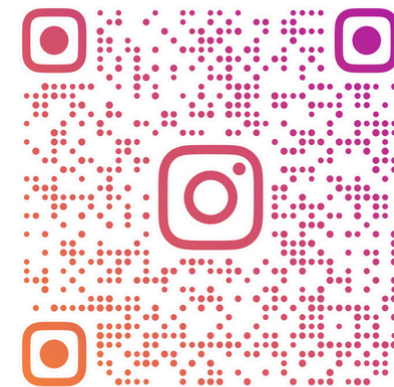
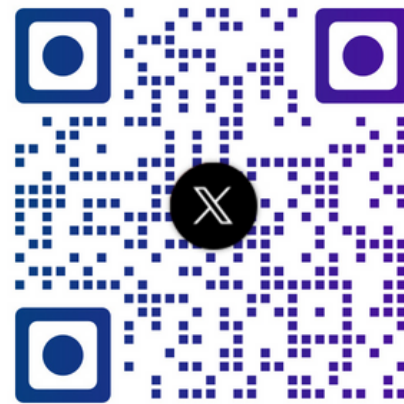
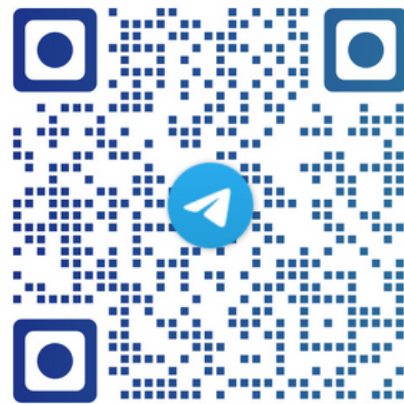

**Sumo Sapphire Building, #738, 15th Cross, JP Nagar 6th  
phase, Bengaluru - 560078**

**Note: We provide fully sanitized private cabs to our customers to visit the site with their family**